

Timber Component Machining Module

The **Timber Component Machining Module** in conjunction with Woodman Production instantly calculates parametric machining points for mortises, router slots, drill holes and tenon sizes for each component in the production job.

Varying machining points for parts such as colonial bars and predetermined variables such as door mid rail heights, variable rail widths, narrow meeting stiles etc. are automatically accommodated to produce a unique set of machining instructions for each component.

The **Timber Component Machining Module** can automatically generate programs for CNC machines such as the Masterwood OMB1CN3KF CNC mortiser/router, Celaschi CNC mortise and tenoners and Homag Woodwop programs.

If required, up to FOUR CNC programs with an unlimited parameter list can be attached to each component. This enables CNC devices to be linked as part of a production line process, allowing for auto-reversal of the parts lists. For example, the first part off the stack into the tenoner would be the last part off the stack going into the mortiser.

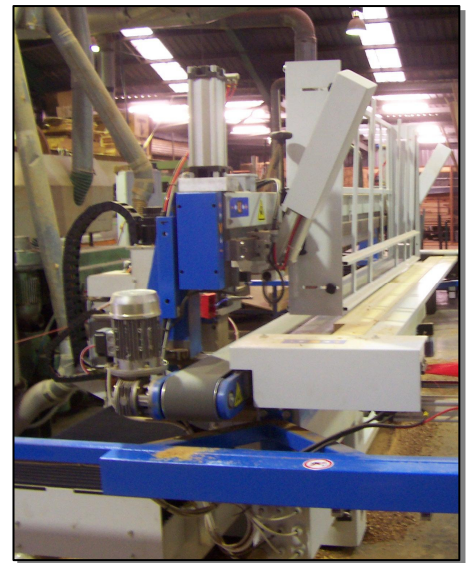
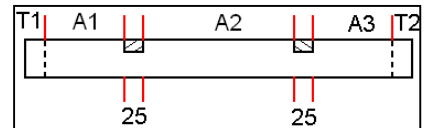

Job : J00005

Machining Schedule For ROUTER

RAIL1GB Sash Rail With 1 Colonial Bar

Part Ref	Part Desc	Size	Qty	Length	Shoulder Size	T1	A1	A2	T2
DHSBM	D/H Sash Bot Mt Rail	47x40	1	1130	1030	50	502.5	502.5	50
DHSBR	D/H Sash Bot Rail	47x80	1	1130	1030	50	502.5	502.5	50
DHSTM	D/H Sash Top Mt Rail	47x40	1	1130	1030	50	502.5	502.5	50
DHSTR	D/H Sash Top Rail	47x60	1	1130	1030	50	502.5	502.5	50

No CNC? No problem.

The Timber Component Machining Module produces a detailed machinist's report

showing finished lengths, shoulder dimensions, tenon lengths, mortise positions and dimensions for each component. Any number of jobs can be batched into one machining list.

This is the 'must have' software for any timber joinery machine shop.

EMB Software Pty Ltd
PO Box 1086
Terrigal
NSW 2260

Tel : 0404 753997
Email: info@emb-software.com
Web : <http://www.emb-software.com>



Embracing Woodworking Technology